

REV	設變內容 MODIFICATION	更改日期 DATE	修改 DRAW

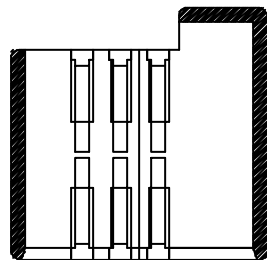

VIEW

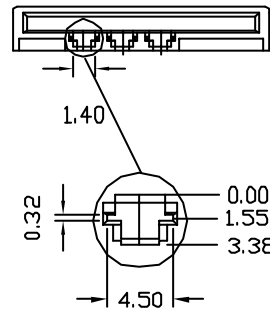
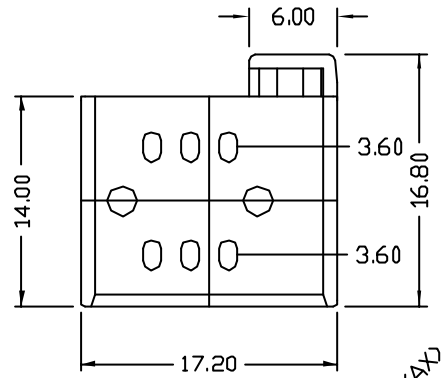
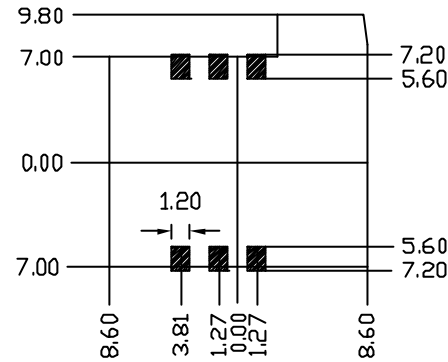
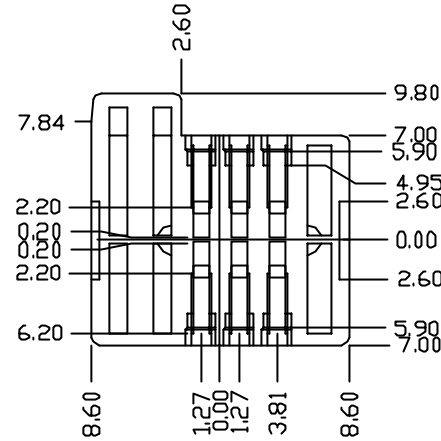
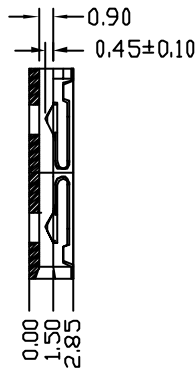
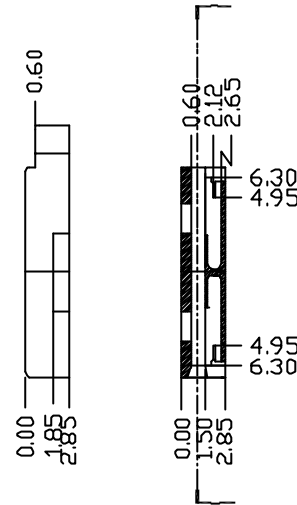

PCB LAYOUT

Specification

- Material:
Insulator: Thermoplastic; Color: black.
Contact: Copper Alloy.
- Plating:
Base Plating: Nickel 50u" over.
Contact area: 30u" Gold selective.
Solder area: Gold flash
- Standard data
Voltage rating: 30V DC
Current rating: 0.5 Amps/contact
Operating temperature: -40° C to +85° C

DIMENSION IN mm [Inch]				
TOLERANCE UNLESS OTHERWISE SPECIFIED			康茂股份有限公司 COMMA ELECTRONIC INC.	
.X±0.3	X:±1"	審核 APPROVE	名稱 TITLE	SIM CARD CONN. CUSTOMER DRAWING
.XX±0.20	.X±0.5'	核對 CHECK	案號 FILE NO.	SC1.35-23
.XXX±0.100	.XX±0.25'	製圖 DRAW	圖號 DWG No.	SCS2.54-3106
			圖紙 SIZE	A4
			角法 PROJ	張數 SHEET
			比例 SCALE	1:1
			更改 REV	A